

Model / Modèle

51-08 Santorini	51-10H Hacienda
51-08C Classico	51-10R Richmond
51-08CP Hammered Copper	51-11 Santorini
51-08H Hacienda	51-16V Viento
51-08R Richmond	51-16 Vulsini
51-10 Santorini	51-22 Vulsini
51-10C Classico	51-37 Santorini
51-10CP Hammered Copper	



Tested & Listed By  Portland Oregon USA
 C US
 OMNI-Test Laboratories, Inc.
Report #0521GM002S
Tested & Certified to
 ANSI Z21.97-2014/CSA 2.41-2014
 CGA 2.17-M91 (R2009)
APPLIANCE BTU RATING
 60,000 Propane / 60,000 Natural Gas

CASUAL FIRESIDE®

A HIGHER STANDARD IN QUALITY AND APPEARANCE - SAFE AND BEAUTIFUL OUTDOOR FIRE PIT FOR PROPANE AND NATURAL GAS (Requires Conversion Kit)

The link below will take you to the Owners Manual and Operating Instructions in French where you can download a copy.

Sélectionnez le lien ci-dessous pour télécharger les instructions françaises.

<http://www.owlee.com/technical-information.aspx>

WARNING: FOR OUTDOOR USE ONLY

BUILDING CODE AND FIXED PIPING SUPPLY REQUIREMENTS: When an appliance is connected to a fixed gas piping supply system, the installation must conform to local building codes, or in the absence of local building codes, to the National Fuel Gas Code, ANSI Z223.1/NFPA 54, International Fuel Gas Code, Natural Gas and Propane Installation Code, CSA B149.1, or Propane Storage and Handling Code, B149.2, as applicable.



WARNING

Improper - installation, adjustment, alteration, service or maintenance of this gas appliance can cause injury or property damage. Read the installation, operating and maintenance instructions thoroughly before installing or servicing this gas appliance.



WARNING

Do not store flammable liquids or use gasoline or other flammable vapor producing products in the vicinity of this or any other gas appliance. An LP- Propane cylinder not connected for use shall not be stored within 60" of this fire pit or any other gas burning appliance.



DANGER

If you smell a gas or a rotten egg odor immediately:

1. Shut off the gas supply to the appliance.
2. Extinguish any open flame.
3. If odor continues, keep away from the appliance and immediately call your gas supplier or the fire department.



This gas appliance is designed as an "attended appliance". Adults must be present when the unit is operating/burning. DO NOT leave this unit operating/burning when unattended. If this product is left operating/burning unattended it may cause serious injury or property damage.



CARBON MONOXIDE HAZARD

This gas appliance can produce carbon monoxide which is an odorless, colorless gas.

Using this gas appliance in an enclosed space can kill you.

Never use this gas appliance in an enclosed space such as a camper, tent, car, home or garage.

INSTALLER - Owner's Manual must be left with the consumer for future reference.

CONSUMER – Owner's Manual must be saved for future reference.

OUTDOOR FIRE PIT - TABLE OF CONTENTS

Table of Contents

Cover - Important Safety Information	1
Important Safety Information and Minimum Clearances to Combustibles	2
Pre-Installation & Preparation Guidelines	3
Important Safety Information	4
Installation Information	
Connecting the Gas to the Fire Pit	5
Certified Media List	6
Glass Media Installation	6
Gem, Mirrored, Tumbled Glass and Ceramic Log Installation	7
Ceramic Rock Media Installation	8
Trouble Shooting Guide	9
Warranty Information	10
Operation Instructions	11
Lighting Instructions	11
Conversion to a Different Gas Type	12

IMPORTANT SAFETY INFORMATION

READ THESE INSTRUCTIONS FULLY BEFORE INSTALLING THIS OUTDOOR FIRE PIT.

If not installed and used correctly per these instructions,
this product can cause serious injury and or property damage and may void the warranty.

CAUTION: FIXED PIPING GAS SUPPLY INSTALLATION, AND REPAIRS MUST BE DONE BY
A CERTIFIED, PROFESSIONAL TECHNICIAN or LICENCED PLUMBER.

Be sure you understand all safety precautions and warnings contained in this manual.
If you have any questions, please contact O.W. Lee at (800) 776-9533

- A. CHECK STATE AND LOCAL BUILDING CODES TO DETERMINE IF THE OUTDOOR FIRE PIT IS PERMITTED IN YOUR LOCALITY BEFORE INSTALLATION.**
- B. FOR OUTDOOR USE ONLY. THIS UNIT MUST BE INSTALLED AT LEAST 60" FROM CENTER OF BURNER TO ANY COMBUSTIBLE WALLS, CEILINGS, OR MATERIAL.**
- C. WHEN SHUTTING OFF THE UNIT — BE SURE TO TURN THE CONTROL VALVE ON THE FIRE PIT TO THE FULLY OFF POSITION ON THE FIRE PIT and CLOSE THE VALVE ON THE PROPANE TANK or NATURAL GAS SUPPLY LINE.**
- D. WARNING: CARBON MONOXIDE POISONING MAY LEAD TO DEATH. DO NOT MODIFY THIS OUTDOOR FIRE PIT OR ITS CONTROLS, EXCEPT AS PROVIDED FOR IN THIS MANUAL.**
- E. IMPROPER INSTALLATION OR USE OF YOUR OUTDOOR FIRE PIT CAN CAUSE SERIOUS INJURY OR DEATH FROM FIRE, BURNS, EXPLOSIONS OR CARBON MONOXIDE POISONING.**

MINIMUM CLEARANCE TO COMBUSTIBLES

<p style="text-align: center;">NOTE MINIMUM OF 60" (1.5 m) CLEARANCE ABOVE THE OUTDOOR FIRE PIT IF INSTALLED UNDER CEILING OR OVERHANG</p> <div style="text-align: center;"> </div>	<p>Clearances to Combustible Construction: Sidewalls: 60" (1.5 m) from center of unit (Figure 1) Ceiling: 60" (1.5 m) from top of unit to ceiling or overhang Flooring: 0" – Can be installed on deck, slab, floor, etc.</p> <hr/> <p>The dimensions shown in Figure 1 are MINIMUM CLEARANCES to maintain when you install this Outdoor Fire Pit. THERE MUST BE AT LEAST 60" of clearance from the center of the unit to any combustible sidewalls, ceilings, or material.</p>
--	---

Figure 1

IMPORTANT SAFETY INFORMATION

Pre-Installation & Preparation Guidelines

- A. Before installing the Outdoor Fire Pit, check "Minimum Clearance to Combustibles" on page 2. **MINIMUM CLEARANCES** must be maintained when you install this Outdoor Fire Pit. **THERE MUST BE AT LEAST 60"** (1.5 m) from the center of the burner to any combustible sidewall, ceiling, or material.
- B. The Outdoor Fire Pit is for outdoor use only. DO NOT install or use this appliance inside a building, garage, or any other enclosed area or structure including recreational vehicles, boats & sheds. **This unit must be installed in such a manner that proper air ventilation is maintained without obstruction at all times, and during all weather conditions.**
- C. **CHECK GAS TYPE** (Natural Gas or Propane): The gas supply you intend to use may not be the same that your fire pit was setup for or is stated on your outdoor rating plate. **THIS FIRE PIT IS CONSTRUCTED FOR USE WITH PROPANE GAS.** If the gas supply is different, **or you wish to change to Natural Gas, you MUST have the Fire Pit Converted (directions to convert can be found on page 12) to the gas type you intend to use. Any gas type conversion should be performed by a qualified, professional technician or licensed plumber.** If you are unsure, contact your dealer for assistance.
- D. **DO NOT USE IF GAS PRESSURE IS LOWER THAN THE MINIMUM REQUIREMENT OR EXCEEDS THE MAXIMUM.**
- E. **GAS PRESSURE REQUIREMENTS: FOR NATURAL GAS:**
The minimum inlet gas supply pressure for purposes of input adjustment is **3.5 inches** (127 mm) water column and maximum inlet gas supply pressure is **10 inches** (254 mm) water column.
FOR PROPANE: The minimum inlet gas supply pressure for purposes of input adjustment is **8 inches** (203 mm) water column and the maximum inlet gas supply pressure is **13 inches** (330 mm) water column.
MANIFOLD PRESSURE REQUIREMENT: Liquid Propane 9.5 (241.3mm) / Natural Gas 2.5 (63.5mm) of pressure.
DO NOT INSTALL THIS UNIT IF MINIMUM PRESSURE IS NOT AVAILABLE OR IF MAXIMUM PRESSURE IS EXCEEDED.
- F. Fixed Gas piping system must be sized to provide minimum inlet pressure at the maximum flow rate (BTU/hr). Undue pressure loss will occur if the pipe is too small or the run is too long.
- G. Casual Fireside Fire Pits are suitable for installation from 0 - 4,500 ft. elevation without modification.
- H. If the Outdoor Fire Pit is connected to a fixed piping gas supply line, the supply line is required to have an on/off gas valve installed before the fire pit and it must be closed during any pressure testing of the system at test pressures in excess of ½ psi (3.5kPa).
- I. If the Outdoor Fire Pit is connected to a fixed piping gas supply line, the supply line is required to have an on/off gas valve installed before the fire pit must be closed during any pressure testing of the system at test pressures equal to or less than ½ psi (3.5kPa).
- J. **INSTALLER NOTE: This unit should be installed so that it can be removed at a later date for service.**
- K. **GAS SUPPLY PLUMBING REQUIREMENTS**
Apply only joint compounds that are resistant to all gasses on all male pipe fittings. Make sure to tighten every joint securely. **DO NOT use pipe joint compound to connect flare fittings.**
- L. **Propane Regulator Hose:** Always inspect the condition of the propane regulator hose before each operation. Any signs of excessive abrasion the hose **MUST BE REPLACED.** Contact your local dealer for replacement part #COM0589
- M. **Propane Regulator Hose** (when used): The propane regulator hose is located inside the fire pit door panel. When installed, make sure the hose is secured inside the unit and **DOES NOT TOUCH THE BURNER PAN.**
- N. **Note: The Use Of A Third Party Fire Pit Top, Media and or Components Will Void the OMNI Certification and O.W Lee Warranty.**
- O. **SAFETY NOTE: An secondary on/off valve, kept in the Off Position, in a fixed piping gas supply line before the fire pit is required for safety when your Outdoor Fire Pit is not in use. It also provides for convenient maintenance and repair.**

IMPORTANT SAFETY INFORMATION

- A. **WARNING: YOUNG CHILDREN SHOULD ALWAYS BE CAREFULLY SUPERVISED WHEN THEY ARE IN THE AREA OF THIS APPLIANCE and IT IS IN USE. SERIOUS INJURY MAY OCCUR**
- B. **WARNING: DO NOT sit or place any part of the body or combustible materials including hair near the Fire Pit Flame.**
- C. **WARNING: Children and adults should be alerted to the hazard of high surface temperatures on the fire pit top surrounding the flame and should stay away to avoid burns and clothing or long hair ignition.**
- D. **WARNING: Every time you use your Fire Pit make sure that the area around the Fire Pit is clear of ALL flammable items such as yard debris, wood, etc. and any flammable vapor producing or flammable liquid items such as gasoline, etc.**
- E. **WARNING: HOT WHILE IN OPERATION AND FOR AT LEAST A HALF HOUR FOLLOWING OPERATION.**
- F. **WARNING: Children must be carefully supervised when in the vicinity of this appliance. Serious injury may occur.**
- G. **WARNING: DO NOT throw trash, paper, plastics or any other flammable materials into your Fire Pit.**
- H. **WARNING: DO NOT leave in operation when unattended.**
- I. **WARNING: DO NOT operate this Fire Pit in the rain.**
- J. **WARNING: DO NOT BURN SOLID FULE IN THIS FIRE PIT.**
- K. **DO NOT** continue using your FIRE PIT if you smell any unusual odors or have headaches, nausea or dizziness.
- L. **DO NOT** store any combustible materials, gasoline, or any other flammable vapors/liquids within 60 inches of your Fire Pit. Provide adequate clearance for servicing and operation.
- M. **Clothing or other flammable materials should not be hung from the appliance, or placed on or near the appliance.** Matches, paper, garbage, plastics or any other material must not be thrown on top of the fire media, burner, or into the flame.
- N. **DO NOT use this appliance if any part of it has been under water.** Call a qualified service technician to inspect the appliance and to replace any part of the control system and any gas control part which has been under water before using.
- O. **Installation and repair should be done by a qualified licensed service technician .** Open the door on the unit to gain access for inspection.
- P. **The appliance should be inspected before use and at least annually by a qualified licensed service technician.** More frequent cleaning may be required as necessary. It is imperative that the propane storage area & inside where the gas control parts are located, the burner and the air/gas mixture piping of the appliance are kept clean and free from spider webs and insects or any other type of obstruction.
- Q. The burner must be replaced prior to the appliance being put into operation if it is evident that the burner is damaged. Replacement burner #COM0590 manufactured by O.W. Lee Company, 1822 E. Francis Street, Ontario CA 91761
- R. Periodically make a visual check of the burner flame to make sure it has not considerably changed in height or coloration since last being used. Any significant change in flame height or coloration is a sign that unit needs to be inspected and serviced or cleaned as required in order to maintain proper safe operation and flame height and coloration.
- S. Cleaning of appliance – Remove lava rock or glass pieces, clean burner with soap and water and dry thoroughly. Clean lava rock or glass pieces with water and dry thoroughly before lighting. Remove any spider webs from inside the unit.

CONNECTING AN LP-GAS CYLINDER/PROPANE TANK TO THE FIRE PIT

IMPORTANT

BEFORE PROCEEDING, CAREFULLY READ ALL OF THE IMPORTANT SAFETY INFORMATION IN THIS OWNER'S MANUAL

- A. Important WARNINGS and Safety Information (Pages 1, 2, 3, 4)
- B. Minimum Clearance to Combustibles (Page 2)

THE LP-GAS CYLINDER (Propane Tank) INFORMATION:

1. Propane Cylinder Size - Capacity: 20 Lbs. (9kg) or 4.7 Gallons (17.8 Liters) of Propane
DO NOT OVERFILL
2. The LP-Gas Cylinder(s) to be used must be constructed and marked in accordance with the U.S. Department of Transportation (D.O.T.) Specifications for LP-Gas Cylinders or the Standard for Cylinders, Spheres and Tubes for Transportation of Dangerous Goods and Commission, CAN/CSA-B339 as applicable.
--Use cylinders approved for your area such as "Blue Rhino" or "AmeriGas" with this appliance. Other cylinders may be acceptable for use with the appliance provided they can be mounted to the appliance using the cylinder retention device provided. (See illustration above.)
--The LP-Gas Cylinder to be used must be provided with a listed overfilling prevention device (OPD) and with a cylinder connection device compatible with the connection for the appliance.
3. Make sure the appliance is NOT in use, and turn OFF the gas at the supply LP-Gas Cylinder Valve.
4. The LP-Gas Cylinder must be disconnected when the appliance is not in use.
5. The LP-Gas Cylinders must be stored outdoors in a well-ventilated area out of the reach of children & at Least 60 inches away for the fire pit. Disconnected cylinders must have threaded valve caps tightly installed and must not be stored in any building, garage, or other enclosed area.
6. The LP-Gas Cylinder must be standing on the designed bottom base of the cylinder for proper vapor withdrawal.

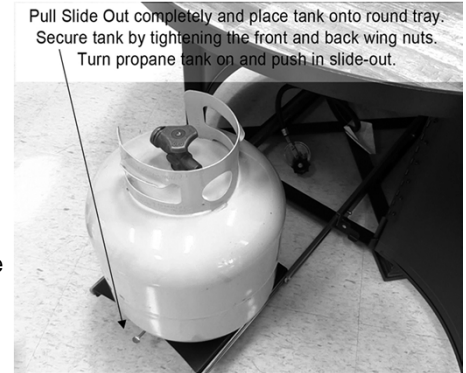

BEFORE INSTALLATION, BE SURE THE LP-GAS CYLINDER/PROPANE TANKS VALVE IS CLOSED.

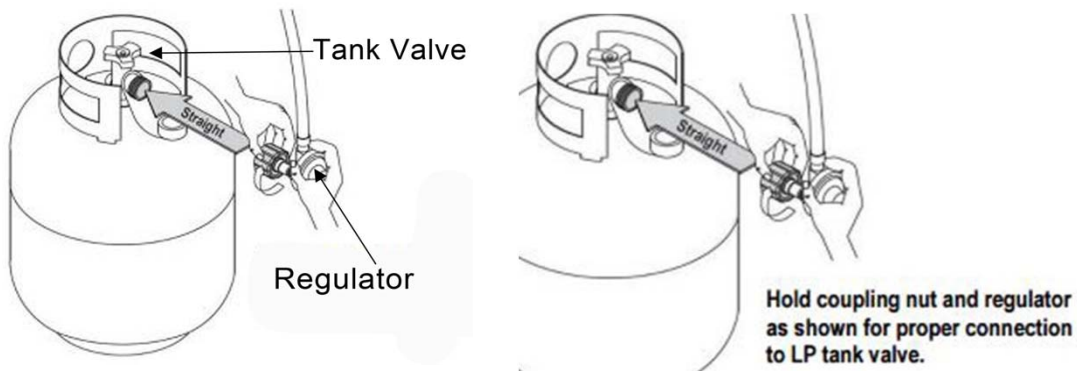

Turn on the gas to the burner system and test for leaks with soapy water solution. (Never use an open flame for testing). If a leak is found, tighten the connector until no leaks are detected. The hose and burner should be inspected before each use of the appliance. The hose assembly must be replaced prior to the appliance being put into operation if there is evidence of excessive abrasion or wear, or if the hose is damaged. The replacement hose shall be that specified by the manufacturer.

LAVA GRANULES MEDIA PLACEMENT

- A. Carefully inspect the carton for shipping damage. If any parts are missing or damaged, call your dealer. **Do not attempt** to install the appliance unless all parts are in good condition.
- B. Correct installation is crucial to safe performance of your Outdoor Fire Pit.
- C. Due to high temperatures, the Fire Pit must be located out of traffic areas and away from combustibles.

LAVA GRANULES AND GLASS MEDIA PLACEMENT



REPLACEMENT PARTS AND MEDIA ARE AVAILABLE THROUGH YOUR LOCAL DEALER

- #1 Stainless Steel X-Burner
- #2 Propane Regulator
- #3 On/Off Control Knob
- #4 Brass Replacement Valve
- #5 Whisper Quiet Flex Line 22"
- #6 Brass Fitting
- #7 Orifice Propane
- #8 Propane to Natural Gas Conversion Kit
- #9 Natural Gas to Propane Conversion Kit

Approved Media:

- #10 Lava Granules 3/8"
- #11 Pebble Fire Glass Kit – Size #3 3/4" – 1/2" (9-19mm)
- #12 Tumbled Fire Glass Kit –Size #3 3/8" – 1/2" (9-12 mm)
- #13 Ceramic Rock Kit with Lava Granules
- #14 Ceramic Log Kit with Lava Granules
- #15 Mirrored Glass Kit - Size 1/4" - (6.35mm)

LAVA GRANULES PLACEMENT

Pour the bag of lava granules media into the Outdoor Fire Pit so that the burner is completely covered.

Figure 1.

Pour the first bag of the lava granules into the burner support.



Figure #1

Figure 2.

Pour the additional bags of granules onto the burner support. Spread the media evenly covering the burner.



Figure #2

CAUTION: BURN HAZARD. LAVA GRANULES WILL REMAIN HOT FOR SOME TIME AFTER USE.

YOU MUST MAINTAIN THE LAYOUT AS SHOWN TO ENSURE PROPER OPERATION OF YOUR FIRE PIT. IF YOU NEED TO REPOSITION ANY MATERIAL TO MAINTAIN THE PROPER LAYOUT, USE HEAT RESISTANT GLOVES OR ALLOW MATERIAL ADEQUATE TIME TO COOL BEFORE HANDLING.

Note: Lava granules used in a fire pit when heated up to normal operating temperatures can cause trapped gasses or moisture in the porous stone to expand and cause a "pop" and "launch" outside of the fire pit, which could cause damage or injury. Caution should be exercised when heating up the fire pit with lava granules to normal operating temperatures.

GEM, MIRRIORED AND TUMBLED GLASS MEDIA PLACEMENT

- A. Carefully inspect the carton for shipping damage. If any parts are missing or damaged, call your dealer. **Do not attempt** to install the appliance unless all parts are in good condition.
- B. Correct installation is crucial to safe performance of your Outdoor Fire Pit.
- C. Due to high temperatures, the Fire Pit must be located out of traffic areas and away from combustibles.

GEM, MIRRIORED AND TUMBLED GLASS MEDIA PLACEMENT

Pour the glass gem / tumbled glass media into the Outdoor Fire Pit so that the burner is completely covered.
(See Figure 1 and 2)

Figure 1.
Pour the first bag of the glass media into the burner support.



Figure 2.
Pour the additional bags of media onto the burner support. Spread the media evenly covering the burner.



CERAMIC LOG MEDIA PLACEMENT

Pour the lava granules into the Outdoor Fire Pit so that the burner is completely covers the burner by 1/2" and spread evenly.
(See Figure 1, 2 and 3)

Figure 1.
Place the largest log diagonally centered over the burner.



Figure 2.
Place the larger three logs as desired using the largest log as the support.



Figure 3.
Place the balance of the logs as desired. Make sure to leave enough air flow.



CAUTION: BURN HAZARD. FIRE PIT MEDIA WILL REMAIN HOT FOR SOME TIME AFTER USE.

YOU MUST MAINTAIN THE LAYOUT AS SHOWN TO ENSURE PROPER OPERATION OF YOUR FIRE PIT. IF YOU NEED TO REPOSITION ANY MATERIAL TO MAINTAIN THE PROPER LAYOUT, USE HEAT RESISTANT GLOVES OR ALLOW MATERIAL ADEQUATE TIME TO COOL BEFORE HANDLING.

Note: Lava granules used in a fire pit when heated up to normal operating temperatures can cause trapped gasses or moisture in the porous stone to expand and may "pop" and "launch" outside of the fire pit, which could cause damage or injury. Caution should be exercised when heating up the fire pit with lava granules to normal operating temperatures.

CERAMIC ROCK MEDIA PLACEMENT

Ceramic Rock Placement (See Figure 1, 2 and 3)

Figure 1.
Pour the lava granules into the burner support covering the burner completely.



Figure 2.
Place the larger rocks
allowing gaps for proper air flow.



Figure 3.
Lay the smaller stones on top of the
larger stones allowing gaps for proper
air flow.



**CAUTION: BURN HAZARD. FIRE PIT MEDIA
WILL REMAIN HOT FOR SOME TIME AFTER USE.
YOU MUST MAINTAIN THE LAYOUT AS SHOWN TO ENSURE PROPER OPERATION OF YOUR FIRE PIT.
IF YOU NEED TO REPOSITION ANY MATERIAL TO MAINTAIN THE PROPER LAYOUT, USE HEAT
RESISTANT GLOVES OR ALLOW MATERIAL ADEQUATE TIME TO COOL BEFORE HANDLING.**

Note: Lava granules used in a fire pit when heated up to normal operating temperatures can cause trapped gasses or moisture in the porous stone to expand and may "pop" and "launch" outside of the fire pit, which could cause damage or injury. Caution should be exercised when heating up the fire pit with lava granules to normal operating temperatures.

TROUBLE SHOOTING GUIDE

PROBLEM	POSSIBLE CAUSE	SOLUTION	NOTES
Propane Tank Does Not Fill	Propane tank was not purged properly	Return the tank to an authorized propane station and re-purge the propane tank.	The Purge process requires that all air is removed from the propane tank prior to the first fill
	The OPD float valve on the propane tank has been activated, closing the valve and not allowing the tank to fill.	Attach the regulator to the propane tank, turn the control valve on for a few seconds to reset the OPD float valve.	The OPD float valve is a safety device which is activated when the propane tank has been filled too quickly.
You Smell Propane or a Rotten Egg Smell	Control valve not closed completely.	To shut off the valve, push the control valve in slightly to unlock and turn to the right (Clockwise) completely.	The far right position on the control valve is the off position
	The regulator was not properly secured to the propane tank.	Disconnect the regulator and reconnect it properly to the propane tank.	The Regulator needs to be tightened securely & fully to the Propane Bottle to prevent propane leaks & to supply the correct amount of propane.
Flame Problems: No Flame Intermittent Flame Low Flame	The tank was not purged properly, it contains a mixture of air and propane. The results is intermittent flame, or flame extinguishes in a short period of time.	Burn off the remaining propane and re-purge the tank.	The purging process requires that ALL the air is removed from the propane tank during to the first fill to ensure maximum efficiency. See your local authorized propane dealer.
	In cooler temperatures, the liquid propane does not convert quickly enough to gas therefore causing the tank to freeze on the outside.	Turn the control valve to the low position where the flow is not a high.	
	Flame setting too low.	To Increase the flame, Turn the control valve clockwise to the 12 o'clock position to get the maximum amount of BTU's.	
	Flame setting too high.	To lower the flame, Turn the control valve counter clockwise from the 12 o'clock position a quarter turn to the set low position and a lower amount of BTU's.	
	Spiders may have created webs or insects may have created nests inside the venturi or orifice.	Make sure the fire pit is not in use & has not been used recently and the unit is cold to the touch so as to not get burned. Make sure the control valve is in the off position. Close the propane tank valve or the fix piping supply line valve. See page 12 of this manual on Converting Your Fire Pit to a Different Gas Type on how to access the venturi & the orifice. Insert a small wire in the venturi & orifice holes to clear passage free of spider webs or other debris. Make sure to put everything back correctly when finished for proper fire pit operation and safety.	This is a common problem when the fire pit has not been used for an extended period of time.
Low or Excessive Flame Using Natural Gas	The water column may not have been adjusted correctly.	Contact your local licensed plumber or certified tech for assistance.	
Fire Pit Wobbles	Cement slab or the use of natural stone may not be completely even.	Optional adjustable fire pit glides are available through your local dealer.	Optional glides are perfect for areas where the draining slope to level out a fire pit.

ADDITIONAL CARE

DO NOT remove the glass wind guards until it has completely cooled, approximately 1/2 hour. Check to be sure that all glass guard connector fittings have not come loose after the cooling process.

DO NOT lift the glass wind guard until connector fittings hardware has been checked and is still secure to the glass guards. Glass connectors may have become loose after use. Make sure all glass connectors are secure after each use of the glass wind guard.

Clean glass wind guards only after completely cool to the touch, approximately 45 minutes after use, with water and white vinegar mix or commercially available streak-free glass cleaner and a soft cloth. **DO NOT** touch glass wind guard for 30-45 minutes following use. **It will be hot.**

Fire Pit Base - Rust seepage and or oxidation may occur in some crevices. The area can be easily serviced by using a detail brush and or fine grit sandpaper. Once the are is clear from rust seepage or oxidation, follow by wiping clean and applying touch-up to seal the crevice. Contact your local dealer for the matching touch-up pen or aerosol.

Hammered Copper Tops - Using a stainless steel polish will help protect & keep the top looking nice. Note: Always use coasters when setting drinks and or food on the top. Spilling acidic drinks and food may discolor the hand applied patina. Should the patina be removed with acidic elements, the area will darken over time.

Porcelain Table Tops - Clean with mild soap and water. Rinse with clean water to remove all soap residue. Note: The grout is made from a durable outdoor epoxy which does not need to be sealed.

WARRANTY INFORMATION

Note: All warranties apply to the original owner only, and begin at the date of purchase. Proof of purchase is required with all claims.

Frame Your OW Lee frame comes with a twenty (20) year structural limited warranty when properly maintained in ordinary home use. OW Lee will, at factory option, repair or replace any OW Lee furniture that has failed structurally during normal use and regular maintenance.

Fire Pit Base - Your OW Lee frame comes with a twenty (20) year structural limited warranty when properly maintained in ordinary home use. OW Lee will, at factory option, repair or replace any OW Lee furniture that has failed structurally during normal use and regular maintenance.

Powder Coat Finish - OW Lee offers a five (5) year limited warranty for frames against blistering, peeling, or fading of the frame finish under normal use and proper maintenance, excluding Oxford White on iron finishes. OW Lee will, at factory option, refinish or replace your OW Lee furniture. If the above occurs within a five year period from the date of purchase. Occasional rust seepage from crevices and hidden unfinished surfaces inherent in some ornate wrought iron designs is considered a care and maintenance function and is not considered a finish failure. To retain the warranty, regular care and maintenance is required. Extra care and maintenance is required in coastal areas.

Cast Aluminum Tops - O.W. Lee offers a five (5) year metal frame limited warranty on its cast/metal hearth and table tops. To retain its warranty, touch-up any scratches or chips. OW Lee will, at factory option, repair or replace any tabletop found to be defective during this warranty period. Regular maintenance must be exercised as set forth in the care instructions. In the event the furniture style, frame finish, fabric or table top has been discontinued, OW Lee will replace the product with a similar item.

Porcelain Tops - OW Lee offers a five (5) year limited warranty on all Porcelain tops from date of delivery. This limited warranty covers the workmanship and structural integrity of the top. Samples displayed or provided to customers are a representation of that series color and are not expressed or implied to be identical. Porcelain tiles are manufactured to mimic natural stone. Some unevenness in the table top surface is considered normal. OW Lee will, at factory option, repair or replace any tabletop found to be defective during this warranty period. Regular maintenance must be exercised as set forth in the care instructions.

Authentic Hammered Copper Tops - OW Lee offers a two (2) year limited warranty on all authentic hammered copper tops from date of delivery. This limited warranty covers the workmanship and structural integrity of the top. The uniqueness of this of the natural materials rests in that no two pieces are ever alike. OW Lee will, at factory option, repair or replace any tabletop found to be defective during this warranty period. Regular maintenance must be exercised as set forth in the care instructions.

Fire Pit Component Parts - O.W. Lee extends a two (2) year limited warranty on all burner components under normal use and proper maintenance. OW Lee will, at factory option, repair or replace any outdoor fire pit burner found to be defective during this warranty period. Regular maintenance must be exercised as set forth in the owner's manual. For more information go to www.owlee.com.

Items Not Covered Under Warranty (Residential)

- This limited warranty does not apply to any damage caused by shipping, accidents, fading, staining, natural weathering, misuse, alterations or repairs. No other person is authorized to assume liability on behalf of OW Lee, and in no event shall OW Lee be liable for any contributory or subsequent damage related to the merchandise purchased from OW Lee.
 - Any failure caused by unreasonable use or abuse.
 - Rust seepage or bleeding from crevices or hidden, non-finished surfaces inherent in some ornate wrought iron designs;
 - Rusting and/or oxidation of frames resulting from exposed metals that have been scratched, chipped or not maintained as outlined in the care and maintenance instructions;
 - Normal fading of frame finish;
 - Accidental damage (including fire, wind or other acts of God).
 - Permanent stains caused by lotions, oils or other substances.
 - Hard-water deposits or calcium build-up due to minerals found in regional water supplies.
 - Table/hearth tops or bases installed and/or used with other manufacturer's table bases, table, or hearth top, or incorrect installation of the base to the table top.
 - Furniture used for commercial or institutional use. (See Commercial Warranty at owlee.com.)
 - Items that are repaired, refinished or otherwise modified by any person or entity other than OW Lee.
- Please Note: Regular maintenance must be exercised as set forth in the care instructions.

Return of Furniture PRIOR AUTHORIZATION from the factory or factory representative is required. You must be the original purchaser and be able to provide proof of purchase when you make a claim. To submit a warranty claim, contact the dealer where you purchased your furniture. If you are not sure how to contact the dealer, contact our warranty department at (800) 776-9533, via fax: (909) 947-6614 and/or via email at owleera@gmail.com.

If the complaint is covered by warranty and the furniture returned within 24 months from the date of purchase. OW Lee will arrange for freight pick-up and pay the surface freight from the dealer location to the factory. The consumer is responsible for freight charges to and from the factory if beyond the timeframe stated above. Return furniture must be cartoned for freight pick up. Furniture must have been used only for residential use as defined in the original purchase order.

Except as expressly provided herein, OW Lee makes no warranties, whether express or implied including, but not limited to, warranties of merchantability and fitness for a particular purpose. OW Lee's limited warranty claims may only be processed directly through OW Lee by the dealer who made the sale of the merchandise. In the event the furniture style, frame finish, fabric or table top has been discontinued, OW Lee will replace the product with a similar item currently offered by OW Lee.

OPERATING INSTRUCTIONS

*We recommend that before you install your Fire Pit you familiarize yourself with the control valve layout. This will help you to be confident operating the Fire Pit when fully installed (see figures below for typical control positions).

FOR YOUR SAFETY, READ BEFORE LIGHTING



WARNING: IF YOU DO NOT FOLLOW THESE INSTRUCTIONS EXACTLY, A FIRE OR EXPLOSION MAY RESULT CAUSING PROPERTY DAMAGE, PERSONAL INJURY OR LOSS OF LIFE.

BEFORE LIGHTING, smell all around the Outdoor Fire Pit area for gas. A rotten egg smell. Be sure to smell close to the floor because propane gas is heavier than air and will settle on the floor.

IF YOU SMELL GAS (A Rotten Egg Odor) FOLLOW THE INSTRUCTIONS ON PAGE 1.

Use only your hand to push in and turn the gas control knob. Never use tools. If the knob will not push in or turn by hand, DO NOT force it. DO NOT try to repair it. Call a qualified, professional service technician. Force or attempted repair may result in fire or explosion.

DO NOT use this appliance if any part has been under water. Immediately call a qualified, professional service technician to inspect the Outdoor Fire Pit and to replace any part of the control system and any gas control that has been under water.

LIGHTING INSTRUCTIONS

STOP - READ SAFETY INFORMATION ABOVE

1. Push in the manual gas control knob slightly and turn clockwise to the "OFF" position.
2. Wait 5 minutes for gas to clear out
3. Place a burning match or hold a lighter stick to the surface of the fire pit media that is covering the burner. Do not hold the match by hand.
4. After the match is burning or the lighter stick is lit and in position, push in the manual gas control knob slightly, and slowly turn the knob counter-clockwise to the "ON" position.
5. The fire pit should lite fairly quickly. If not repeat Steps 1-4 until fire pit is lit.



Shutting Off The Fire Pit

1. Push in the manual gas control knob slightly and turn clockwise to the "OFF" position.
2. After the fire pit has been turned off, wait 5 minutes for gas to clear out
3. After the fire pit has completely shut off and is cooled down. Close the propane tank valve or natural gas servicing valve to the "off" position to ensure no gas is leaking while not in use.

CONVERTING YOUR FIRE PIT TO A DIFFERENT GAS TYPE



- MAKE SURE THAT THE GAS SUPPLY TO THE FIRE PIT (AND ANY NEARBY ELECTRICAL SOURCES/APPLIANCES) ARE SHUT OFF.**
- Carefully detach the flex line connector hose attached to the orifice holder (Figure # 1) and unscrew the orifice holder from the burner pipe (Figures #1 and # 2).
- Remove the orifice from the holder (Figure # 2) and replace it with the proper sized one for your gas requirement. Propane requires the smaller orifice.
- If you are converting from propane (LP) gas to natural gas, install the air shutter sleeve so that the air intake holes are closed (Figure #2). For Propane gas, remove the air shutter so that the air intake holes are open (Figure #1). **After the unit is assembled for use, it is requires a "leak check" test on all connections are before placing the unit in operation.**
- IT IS NECESSARY TO ATTACH THE LABEL OR RATING PLATE INCLUDED WITH THE CONVERSION KIT TO CLEARLY INDICATE THE FIELD CONVERSION.

<p>FIGURE 1</p>	<p>Casual Fireside Fire Pits Are Suitable For Installation from 0 - 4,500 ft. Without Modification.</p>
<p>FIGURE 2</p>	<p>Follow steps 1 – 5 shown above. THE CONVERSION SHALL BE CARRIED OUT BY A MANUFACTURER'S AUTHORIZED REPRESENTATIVE, IN ACCORDANCE WITH THE REQUIREMENTS OF THE MANUFACTURER, PROVENCIAL OR TERRITORIAL AUTHORITIES HAVING JURISDICTION AND IN ACCORDANCE WITH THE REQUIREMENTS OF THE CAN/CGA-B149.1 OR CAN/CGA-B149.2 INSTALLATION CODES. After conversion follow Operating Instructions found on Page 11.</p> <p>After The Unit Is Converted, it Must Be Tested to Verify the Inlet and Manifold pressures are as specified on Page 3. Additionally, the authorized representative must verify that the input rate of the converted appliance match the rate listed below.</p>

MANUFACTURER'S USE ONLY - QUALITY CHECK		Date _____	
Orifice # (Main)	_____ #40 _____	Work Order #	_____
Orifice # (OTHER)	_____ #12 / COM0590CK _____	BTU Rating	LP 60,000 / NG 60,000
Leak Test	_____	Serial #	_____
Burn Test	_____	Model #	COM0590
Gas Type	_____ (LP)- NAT _____	Air Shutter Sleeve	X
		Inspector:	_____